



# UNIVERSAL ELECTRIC MOTORS

2014 • 2015

# HEATING MOTOR CATALOGUE

## NEW THIS SEASON

- ✓ EXPANDED RANGE OF FLUE EXHAUST BLOWERS
- ✓ NEW ELCO REPLACEMENT MOTORS
- ✓ OIL BURNER MOTORS
- ✓ HOT WATER CIRCULATOR MOTORS
- ✓ NEW UNIT HEATER MOTORS
- ✓ 1 & 3 PH. BELT DRIVE BLOWER MOTORS
- ✓ CENTRIFUGAL BLOWERS



OMNIDRIVE®

FASCO

WE DO MOTORS BEST.



[www.uem.ca](http://www.uem.ca)

**Features:**

- All Angle Mount
- Continuous Duty, Air Over
- Shaded Pole
- Thermally Protected
- Sleeve & Ball Bearings

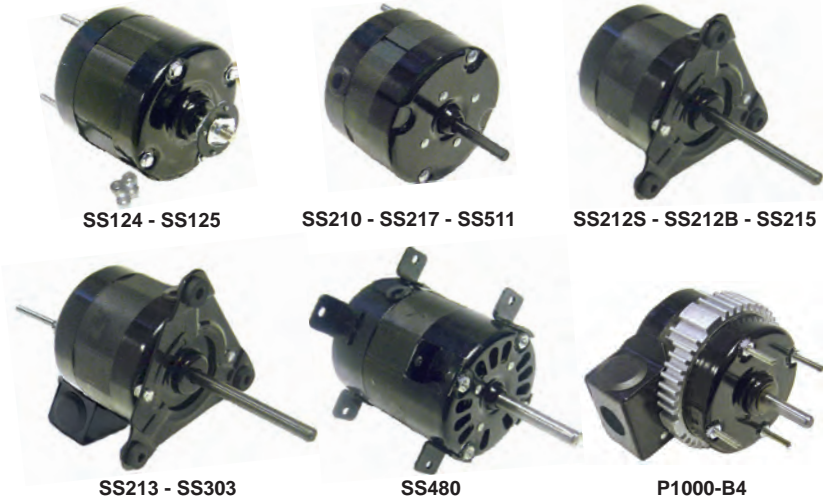

3.3" Diameter

OMNIDRIVE®

Stock #	Encl.	HP	Volts	Amps.	RPM	Shaft	Rotation	Replaces
SS124	T.E.	1/20	115	1.55	1550	Hubless	CWSE	R124
SS125	T.E.	1/20	230	0.80	1550	Hubless	CWSE	R125
SS210	T.E.	1/50	230	0.40	1550	1/4" x 1.56"	CWSE	R210
SS212B •	T.E.	1/35	240	0.55	1550	5/16" x 3-1/2"	CWSE	R212
SS212S	T.E.	1/30	240	0.55	1550	5/16" x 3-1/2"	CWSE	---
SS213	T.E.	1/25	115	1.40	1550	5/16" x 1.78"	CWSE	R213
SS215	T.E.	1/300	240	0.24	1200	5/16" x 2-1/4"	CWSE	R215
SS217	T.E.	1/40	240	0.50	1550	1/4" x 1.56"	CCWSE	R217
SS303 •	OPEN	1/25	115	1.50	1550	5/16" x 3.28"	CWSE	R303
SS480	OPEN	1/30	208-240	0.80	1500	3/8" x 2.38"	CWSE	R480
SS511	T.E.	1/350	240	0.38	1350	1/4" x 2.05"	CCWSE	R511
P1000-B4 •	T.E.	1/20	120	1.70	1600/2	5/16" x 1.63"	CWSE	R400

## Skeleton Motors & Kits

**Features:**

- Impedance or Thermally Protected
- Continuous Duty, Air Over
- Mechanically Reversible
- Class 'B' Insulation



'C' Frame Skeleton

OMNIDRIVE®

Stock #	Stack	Volts	Amps.	RPM	Shaft	Rotation	Replaces
SS617	3/8	208-240	0.22	1900	3/16" x 1-1/4"	CWSE	R617
SS635	1-1/2	208-240	1.20/0.83	1550	1/4" x 1-1/2"	CCWSE	R635
SS3670	5/8	120/240	0.40/0.26	3000	3/16" x 1-9/16"	CWSE	R3670
SS3100	5/8	115	0.59	3000	7/32" x 1-11/16"	CCWSE	R3100, C01550 EM550, VFM100 SM550, C65878

**Features:**

- Shaded Pole Design
- Sleeve Bearings
- Replacements for Reversomatic & Intercity



SS630



SS260 - SS262- SS264



SS266



SS2603 - SS2604



SS2605



SS2609 - SS2612

## OEM Replacements

OMNIDRIVE®

Stock #	Encl.	HP	Volts	Amps.	RPM	Shaft	Rotation	Replaces
SS630	OPEN	---	120	0.75	3000	7/32" x 1-13/16"	CCWSE	R630
SS260	T.E.	1/90	115	0.60	1500	5/16" x 1.09"	CCWSE	R260
SS262	T.E.	1/40	115	1.10	1550	5/16" x 1-1/2"	CCWSE	R262
SS264	T.E.	1/75	120	0.70	1550	5/16" x 2.06"	CCWSE	R264
SS266	T.E.	1/20	120	1.45	1550	5/16" x 1.40"	CCWSE	R266
SS2603	OPEN	1/35	115	1.15	1550	1/2" x 2.10"	CCWSE	R2603
SS2604	OPEN	1/10	120	2.65	1550	1/2" x 2.05"	CCWSE	R2604
SS2605	OPEN	1/12	115	3.00	1050	1/2" x 1.98"	CCWSE	R2605
SS2609	T.E.	1/30	115	1.21	1550	1/2" x 2.35"	CCWSE	R2609
SS2612	T.E.	1/30	115	1.21	1550	1/2" x 2.35"	CWSE	R2612

## Fan Coil Motors

**Features:**

- P.S.C. Design
- Capacitor Included
- Sleeve Bearings
- Replacements for Temspec, Unilux, Climetec & Snyder-General



All Models

### 42 & 48 Frame

OMNIDRIVE®

Stock #	Encl.	HP	Volts	Amps.	RPM	Shaft	Rotation	Replaces
SS799 *	OPEN	1/8	115	2.10	1000/5	1/2" x 5.00"	CWSE	DD-029
SS2799 *	OPEN	1/6	115	2.60	950/5	1/2" x 4.40"	CWSE	DD-030

(\*) P.S.C. Design

### Features:

- Continuous Duty
- Class 'B' Insulation
- UL Listed & CSA Approved
- Thermally Protected
- Sleeve & Ball Bearings
- 60 Hz

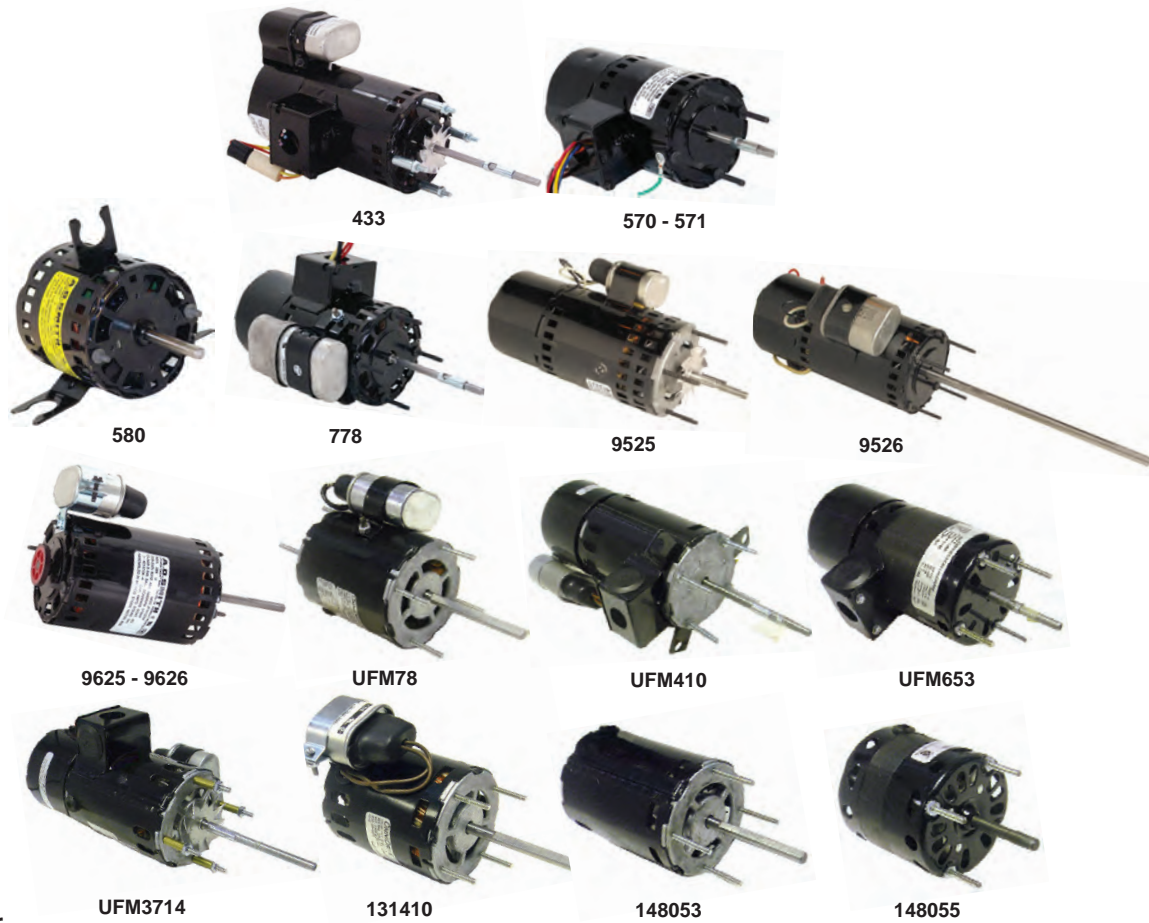

3.3" Diameter



Stock #	Encl.	HP	Volts	Amps.	RPM	Shaft	Rotation	Replaces
433 •*	OPEN	1/20	115/208-230	0.71/0.38	1550	1/4" x 4-1/4"	REV.	---
570 •*	OPEN	1/20	115/230	1.80/0.92	3000	1/4" x 2-1/2"	CWSE	RFM5, D456
571 •*	OPEN	1/20	115/230	1.80/0.92	3000	1/4" x 2-1/2"	CCWSE	RFM4, D457
580	OPEN	1/20	115	1.80	3300	5/16" x 2-1/8"	CWSE	RFM580, D1180
778 •*	OPEN	1/16	208-230	0.41	3450	1/4" x 3-3/4"	CWSE	RFM680, D1178
9525 •	OPEN	1/12	460	0.20	3400	1/4" x 2-1/2"	CCWSE	RFM460
9526 •	OPEN	1/10	460	0.30	3400	3/8" x 8-3/4"	CCWSE	RFM187
9625 •	OPEN	1/16	460	0.25	3450	5/16" x 3-1/4"	CCWSE	RFM462, D1184
9626 •	OPEN	1/16	208-230	0.48	3450	5/16" x 3-1/4"	CCWSE	RFM232, D1182
UFM78 •	OPEN	1/10	115/230	1.30/0.70	3200	5/16" x 3-1/4"	REV.	RFM78
UFM410 •*	OPEN	1/10	115/230	1.40/0.70	3000	1/4" x 3.70"	REV.	RFM410, D410
UFM653 •*	OPEN	1/12	230/460	1.20/0.60	3000	1/4" x 2-1/4"	CCWSE	RFM653
UFM3714 •*	OPEN	1/8	115/208-230	1.60/0.80	3200	1/4" x 4.00"	REV.	---
131410 •*	OPEN	1/10	115	1.60	3000	5/16" x 3.20"	CWLE	131410
148053 •*	OPEN	1/20	115	0.70	3300	5/16" x 3.00"	CWSE	148053
148055	OPEN	1/33	115	1.00	3300	5/16" x 2.00"	CWSE	148055

(433,570,571,778,UFM410,UFM653,UFM3714 motors include 1/4" to 5/16" Bushing)

# Universal Silicon Nitride Igniter Kits

**Features:**

- 7 Replacements for virtually all types of older igniters
- A Silicon Nitride Hot Surface Igniter has been designed to take the place of any type of silicon carbide igniter.
- Silicon Nitride has high fracture toughness and good chemical resistance that can be handled with the greasiest of hands.
- The round igniters light the gas in a way that's energy efficient, requiring less than half the energy to power them.
- Replaces most popular OEM and competitor brand igniters.
- All igniters come with a 3 Year Warranty



HSIURK80V



HSIURK120V413



HSIURK120V401



HSIURK120V406



HSIURK120VF



HSIURK120VR



SLURK24V

- **Replacements for popular brands such as:** Amana, American Appliance, American Road Equip, Arco, Armstrong Air, Carlin, Carrier, Clare Brothers, Coleman, Comfort Zone, Detroit/Brant Radiant, DMO/Olsen ECR Ind, Dornback Furnace, Ducane, Enerco Tech, Evcon, Goodman, H.B. Smith, Heil, Hupp Ind, Intercity, Janitrol, LB White, Majestic, Metzger, Mor-Flo, Nordyne, Norton, Perfection Schwank, Raypak, Rheem Rudd, Robertshaw Uni-line, Roberts Gordon, Smith HB, Snyder General, Supco, Superior Furnace, Tempstar, Trane, Trianco Heatmaker, Viessmann, Wayne Home Equipment, White Rogers, Weil McLain, Williamson, York/Luxaire



New Product

## Airease

Stock #	Type	HP	Volts	Amps.	RPM	Bearings	Rotation	Replaces
A081	S.P.	1/60	230	0.50	3000	Ball	CWLE	---

## Amana

Stock #	Type	HP	Volts	Amps.	RPM	Bearings	Rotation	Replaces
A180	S.P.	1/30	115	1.80	3400	Ball	CCWSE	---
A280	S.P.	1/25	115	1.50	3000	Sleeve	CWSE	RFB280
A283	S.P.	1/25	115	1.50	3000	Sleeve	CCWSE	---
UFB111	S.P.	1/25	115	1.15	3000	Sleeve	CWSE	RFB111
UFB129	S.P.	1/20	115	1.95	3250	Sleeve	CWSE	RFB129, A129
UFB158	P.S.C.	1/25	115	0.70	3450	Sleeve	CWSE	RFB158, A158
UFB160	S.P.	1/30	115	1.60	3000	Sleeve	CWSE	RFB160, A160

## Armstrong

Stock #	Type	HP	Volts	Amps.	RPM	Bearings	Rotation	Replaces
A155	S.P.	1/25	115	1.40	3000	Sleeve	CCWSE	RFB425
UFB547	S.P.	1/20	115	1.80	3400	Ball	CCWSE	RFB547, A163

## Carrier

Stock #	Type	HP	Volts	Amps.	RPM	Bearings	Rotation	Replaces
9626	P.S.C.	1/16	208-230	0.48	3450	Sleeve	CCWSE	RFM232, D1182
9625	P.S.C.	1/16	460	0.25	3450	Ball	CCWSE	RFM462, D1184
UFB212	S.P.	1/30	115	1.60	3000	Ball	CCWSE	RFB212

## Clare

Stock #	Type	HP	Volts	Amps.	RPM	Bearings	Rotation	Replaces
9619	S.P.	1/30	115	1.35	3200	Sleeve	CWLE	RFB140, A140
9457	P.S.C.	1/20	115	0.70	3350	Sleeve	CWSE	RFB130, A130
UFB17	S.P.	1/15	115	2.00	3000	Sleeve	CCWSE	RFB17

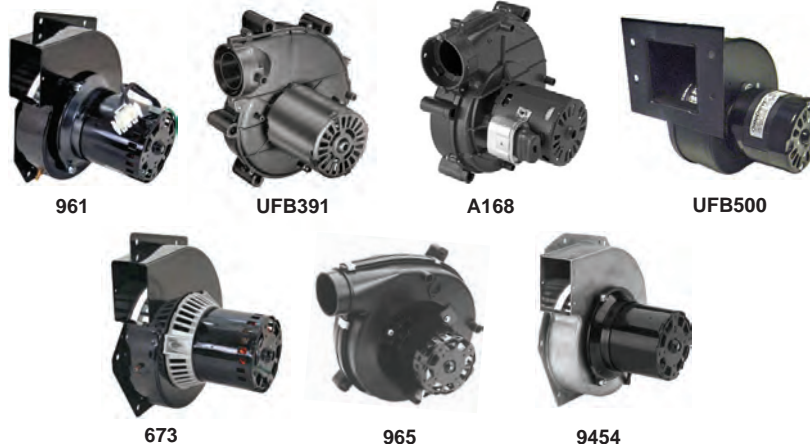

New Product

### Coleman

Stock #	Type	HP	Volts	Amps.	RPM	Bearings	Rotation	Replaces
961	S.P.	1/50	115	0.90	3300	Sleeve	CCWSE	RFB156
UFB391	S.P.	1/25	115	1.30	3200	Sleeve	CWSE	RFB391, A088

### Dornback

Stock #	Type	HP	Volts	Amps.	RPM	Bearings	Rotation	Replaces
UFB391	S.P.	1/25	115	1.30	3200	Sleeve	CWSE	RFB391, A088

### Ducane



Stock #	Type	HP	Volts	Amps.	RPM	Bearings	Rotation	Replaces
A168	P.S.C.	1/10	115	0.70	3450	Ball	CCWSE	RFB540

### Dundas Foundry

Stock #	Type	HP	Volts	Amps.	RPM	Bearings	Rotation	Replaces
UFB500	S.P.	1/33	115	1.10	2860	Sleeve	CCWSE	RFB500, UE9492

### Evcon

Stock #	Type	HP	Volts	Amps.	RPM	Bearings	Rotation	Replaces
961	S.P.	1/50	115	0.90	3300	Sleeve	CCWSE	RFB156, A156

### FlameMaster

Stock #	Type	HP	Volts	Amps.	RPM	Bearings	Rotation	Replaces
673	S.P.	1/50	115	1.00	3000	Sleeve	CWSE	RFB111, AIC111

### Frigidaire

Stock #	Type	HP	Volts	Amps.	RPM	Bearings	Rotation	Replaces
965	P.S.C	1/20	115	0.70	3400	Sleeve	CCWLE	RFB902
9454	S.P.	1/50	115	1.10	3000	Sleeve	CWSE	RFB903, A131

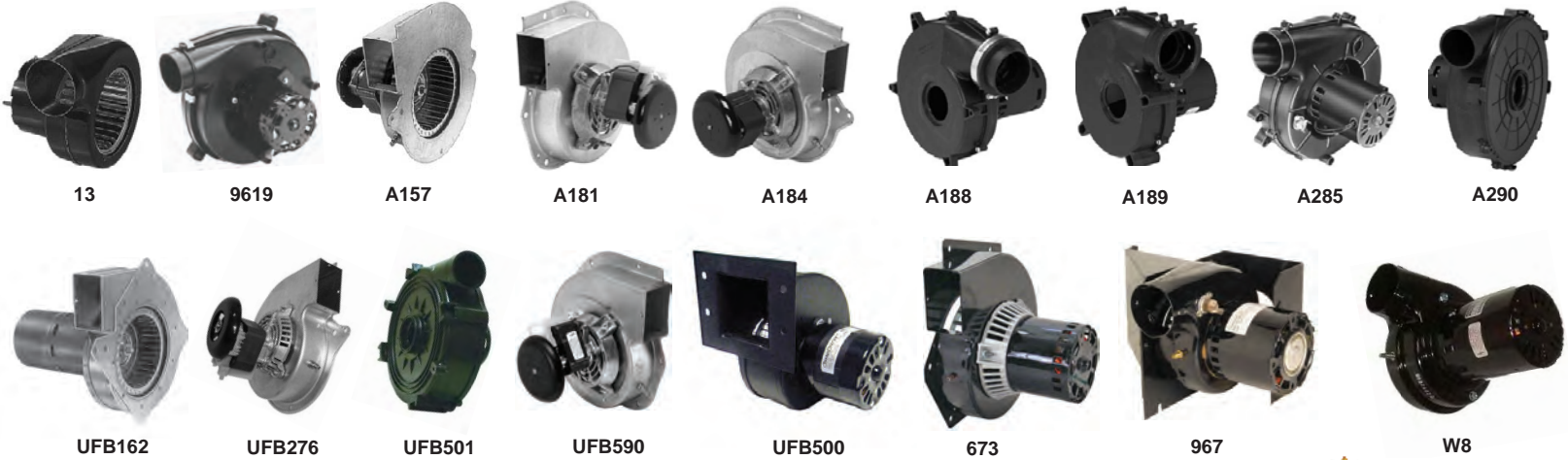

**New Product**

## Gasmac

Stock #	Type	HP	Volts	Amps.	RPM	Bearings	Rotation	Replaces
13	S.P.	1/40	115	1.00	3000	Sleeve	CCWSE	RB3

## Goodman

Stock #	Type	HP	Volts	Amps.	RPM	Bearings	Rotation	Replaces
9619	S.P.	1/30	115	1.35	3200	Sleeve	CCWLE	RFB140, A140
A157	S.P.	1/35	115	1.30	3000	Sleeve	CCWSE	RFB185
A181	S.P.	1/30	115	1.20	3192	Ball	CWSE	---
A184	S.P.	1/35	115	1.55	3125	Ball	CCWSE	RFB859
A188	S.P.	1/18	115	1.60	3250	Sleeve	CWSE	RFB483
A189	S.P.	1/24	115	1.50	3000	Sleeve	CWSE	---
A285	S.P.	1/40	115	1.40	3250	Sleeve	CWSE	---
A290	P.S.C.	1/20	115	0.70	3200/2400	Ball	CCWSE	RFB547
UFB162	S.P.	1/50	208-230	0.50	3000	Sleeve	CCWSE	RFB162, A162
UFB276	S.P.	1/50	115	1.22	3000	Ball	CCWSE	RFB276
UFB501	S.P.	1/20	115	2.80	3000	Ball	CCWSE	RFB501
UFB590	S.P.	1/35	115	1.30	3000	Sleeve	CCWSE	RFB590, A182

## Greenhouse

Stock #	Type	HP	Volts	Amps.	RPM	Bearings	Rotation	Replaces
UFB500	S.P.	1/33	115	1.10	2860	Sleeve	CCWSE	RFB500, UE9492

## Grimsby

Stock #	Type	HP	Volts	Amps.	RPM	Bearings	Rotation	Replaces
673	S.P.	1/50	115	1.00	3000	Sleeve	CWSE	RFB111, AIC111

## G.S.W.

Stock #	Type	HP	Volts	Amps.	RPM	Bearings	Rotation	Replaces
967	S.P.	1/30	115	1.71	3000	Sleeve	CCWLE	RFB127
W8	S.P.	1/20	115	1.30	3200	Sleeve	CCWSE	RFB172





New Product

### Heil Quaker

Stock #	Type	HP	Volts	Amps.	RPM	Bearings	Rotation	Replaces
776	S.P.	1/50	230	0.40	3200	Sleeve	CCWLE	RFB105, A151
UFB134	S.P.	1/25	115	1.50	3050	Sleeve	CWSE	RFB134, A134
UFB141	S.P.	1/60	115	1.00	2800	Ball	CWSE	RFB141, A141

### Intercity Products (Keeprite)

Stock #	Type	HP	Volts	Amps.	RPM	Bearings	Rotation	Replaces
776	S.P.	1/50	230	0.40	3200	Sleeve	CCWLE	RFB105, A151
9453	S.P.	1/50	115	1.10	3000	Sleeve	CCWSE	RFB68, A179
A051	S.P.	1/60	115	1.60	3000	Ball	CWSE	RFB833
A148	S.P.	1/50	208-230	0.50	3000	Sleeve	CCWSE	---
A171	P.S.C.	1/25	115	0.70	3450	Ball	CCWSE	RFB145
A174	S.P.	1/100	115	0.80	2350	Sleeve	CWSE	---
A175	S.P.	1/40	115	1.00	3300	Sleeve	CCWSE	---
A176	S.P.	1/25	115	2.20	3100	Ball	CWSE	---
A177	S.P.	1/36	115	1.40	3000	Ball	CWSE	---
A179	S.P.	1/50	115	0.90	3000	Sleeve	CWSE	RFB68
A301	S.P.	1/100	115	0.80	2350	Sleeve	CWSE	---
A306	P.S.C.	1/30	208-230	0.30	3350	Sleeve	CCWSE	RFB107
UFB330	S.P.	1/20	115	2.60	3000	Ball	CWSE	RFB330
UFB702	S.P.	1/25	115	2.30	2800	Ball	CCWSE	RFB170
UFB811	S.P.	1/30	115	1.80	3400	Ball	CWSE	---
UFB134	S.P.	1/25	115	1.50	3050	Sleeve	CWSE	RFB134, A134
UFB141	S.P.	1/60	115	1.00	2800	Ball	CWSE	RFB141, A141
UFB145	P.S.C.	1/25	120	0.70	3450	Ball	CCWSE	RFB145, A145
UFB350	P.S.C.	1/18	115	0.80	3450	Ball	CCWSE	RFB350, A173



New Product

## Johnson

Stock #	Type	HP	Volts	Amps.	RPM	Bearings	Rotation	Replaces
464	S.P.	1/60	208-230	0.55	3000	Ball	CCWSE	RFB6
UFB547	S.P.	1/20	115	1.80	3400	Ball	CCWSE	RFB547, A163

## John Woods

Stock #	Type	HP	Volts	Amps.	RPM	Bearings	Rotation	Replaces
967	S.P.	1/30	115	1.71	3000	Sleeve	CCWLE	RFB127

## Lennox

Stock #	Type	HP	Volts	Amps.	RPM	Bearings	Rotation	Replaces
9496	P.S.C.	1/10	208-230	0.55	3000	Ball	CWSE	RFB101, 074
A068	S.P.	1/60	120	1.15	3000	Ball	CCWSE	RFB840
A138	S.P.	1/70	120	0.70	3000	Sleeve	CCWSE	RFB138
A200	S.P.	1/30	115	1.95	3000	Sleeve	CCWSE	RFB495
A202	S.P.	1/30	115	1.80	3400	Ball	CCWSE	---
A322	S.P.	1/70	120	1.10	3000	Sleeve	CCWSE	---
A329	P.S.C.	1/12	208-230	1.80	3200	Ball	CWSE	---
D1198	S.P.	1/30	115	1.50	3200	Sleeve	CCWSE	---
UFB135	S.P.	1/60	120	0.70	3000	Sleeve	CCWSE	RFB135, A135
UFB164	S.P.	1/50	120	0.80	3400	Sleeve	CCWSE	RFB164, A164
UFB282	S.P.	1/16	115	2.10	3000	Ball	CWSE	RFB282
UFB320	P.S.C.	1/10	460	0.38/0.33	3200	Ball	CWSE	RFB320, A331
UFB385	P.S.C.	1/20	115	0.80	3200/2	Ball	CCWSE	RFB385, A209

continued on next page...



New Product

Lennox (Continued)

Stock #	Type	HP	Volts	Amps.	RPM	Bearings	Rotation	Replaces
UFB390	S.P.	1/65	120	0.70	3000	Sleeve	CCWSE	RFB390, A219
UFB547	S.P.	1/20	115	1.80	3400	Ball	CCWSE	RFB547, A163
UFB550	S.P.	1/16	230	0.83	3000	Ball	CCWSE	RFB550, A217
UFB701	P.S.C.	1/10	208-230	0.60	3200	Ball	CWSE	RFB701, A325
UFB790	S.P.	1/28	115	1.80	3000	Ball	CCWSE	RFB790, A207
UFB810	S.P.	1/28	115	1.80	3000	Ball	CCWSE	RFB810, A208
UFB811	S.P.	1/15	115	2.40	3400	Ball	CCWSE	RFB811, A211
UFB890	S.P.	1/25	115	1.50	3000	Sleeve	CCWSE	---

Magic Chef

Stock #	Type	HP	Volts	Amps.	RPM	Bearings	Rotation	Replaces
464	S.P.	1/60	208-230	0.55	3000	Ball	CCWSE	RFB6

Miller

Stock #	Type	HP	Volts	Amps.	RPM	Bearings	Rotation	Replaces
965	P.S.C.	1/20	115	0.70	3400	Sleeve	CCWLE	RFB902
9454	S.P.	1/50	115	1.10	3000	Sleeve	CWSE	RFB903, A131

Newmac

Stock #	Type	HP	Volts	Amps.	RPM	Bearings	Rotation	Replaces
UB33	S.P.	1/60	115	0.88	3200	Sleeve	CWSE	RB33

Nordyne

Stock #	Type	HP	Volts	Amps.	RPM	Bearings	Rotation	Replaces
965	P.S.C.	1/20	115	0.70	3400	Sleeve	CCWLE	RFB902
9454	S.P.	1/50	115	1.10	3000	Sleeve	CWSE	RFB903, A131
A122	S.P.	1/17	115	1.75	3000	Sleeve	CWSE	---
A123	S.P.	1/18	115	1.95	3300	Ball	CWSE	---
A124	S.P.	1/15	115	1.75	3000	Sleeve	CWSE	---
A131	S.P.	1/50	115	1.10	3000	Sleeve	CWSE	---



**New Product**

## Olsen

Stock #	Type	HP	Volts	Amps.	RPM	Bearings	Rotation	Replaces
9457	P.S.C.	1/20	115	0.70	3350	Sleeve	CWSE	RFB130, A130
9619	S.P.	1/30	115	1.35	3200	Sleeve	CCWLE	RFB140, A140
UFB111	S.P.	1/25	115	1.20	3000	Sleeve	CCWSE	RFB111
UFB112	S.P.	1/45	115	1.30	3000	Sleeve	CCWSE	RFB112
UFB200	S.P.	1/24	115	1.80	3200	Ball	CWSE	RFB200

## Rheem / Ruud

Stock #	Type	HP	Volts	Amps.	RPM	Bearings	Rotation	Replaces
577	S.P.	1/50	115	1.00	3000	Sleeve	CCWSE	RFB214, A079
9438	S.P.	1/50	115	1.10	2975	Sleeve	CWLE	RFB090
A066	S.P.	1/30	115	1.27	3000	Ball	CWSE	RFB241
A242	S.P.	1/50	115	1.36	3400	Sleeve	CWSE	---
A243	S.P.	1/50	115	1.36	3400	Sleeve	CWSE	---
A245	S.P.	1/15	208-230	0.95/0.80	3000	Ball	CWSE	---
A247	P.S.C.	1/40	115	0.95	3250/2800	Sleeve	REV	---
UFB139	S.P.	1/55	115	0.95	3000	Sleeve	CWSE	RFB139, A139
UFB206	P.S.C.	1/20	115	0.90	3400	Ball	CWSE	RFB206, A246
UFB189	S.P.	1/40	115	1.00	3000	Ball	CCWSE	RFB189
UFB641	S.P.	1/25	208-230	0.60	3200	Sleeve	CWSE	RFB641, A241

## Skymark

Stock #	Type	HP	Volts	Amps.	RPM	Bearings	Rotation	Replaces
A251	S.P.	1/35	208-230	1.10	3000	Sleeve	CCWSE	---

## State Water Heater

Stock #	Type	HP	Volts	Amps.	RPM	Bearings	Rotation	Replaces
W10	S.P.	1/20	115	1.80	3400	Sleeve	CCWSE	---

## Schwank

Stock #	Type	HP	Volts	Amps.	RPM	Bearings	Rotation	Replaces
UB579	S.P.	1/30	115	1.20	3000	Sleeve	CCWSE	---



New Product

### Tappan

Stock #	Type	HP	Volts	Amps.	RPM	Bearings	Rotation	Replaces
582	S.P.	1/40	115-230	0.82	3000	Ball	CWSE	RFB73

### Trane

Stock #	Type	HP	Volts	Amps.	RPM	Bearings	Rotation	Replaces
774	S.P.	1/50	208-240	0.42	3000	Sleeve	CWLE	RFB73, UE774
9457	P.S.C.	1/20	115	0.70	3350	Sleeve	CWSE	RFB130, UE9457
A075	S.P.	1/40	230	0.40	3000	Sleeve	CCWSE	---
A146	S.P.	1/100	115	1.00-0.35	3000	Sleeve	CWSE	---
A193	S.P.	1/35	208-240	0.59/0.50	3480	Ball	CCWSE	---
A195	S.P.	1/16	115	1.75	3400	Ball	CWSE	---
A196	S.P.	1/25	115	1.35	3200	Sleeve	CWSE	---
A197	3 PHASE	1/70	33-110	1.00	1500-4700	Ball	CWSE	---
A199	S.P.	1/45	115	1.75	3000	Ball	CWSE	---
A269	S.P.	1/35	208-230	0.60	3000	Ball	CCWSE	---
A270	P.S.C.	1/15	208-230	0.50	2800	Ball	CCWSE	---
A271	P.S.C.	1/18	208-230	0.62	3500	Ball	CWSE	---
A272	P.S.C.	1/12	208-230	0.65	3500	Ball	CWSE	---
A273	P.S.C.	1/8	208-230	0.62	3500	Ball	CWSE	RFB310
A274	P.S.C.	1/24	208-230	0.28	3500	Ball	CWSE	---
A276	S.P.	1/55	115	1.00	3000	Sleeve	CWSE	---
A361	S.P.	1/42	115	1.60	3000	Ball	CWSE	RFB787, RFB337
A368	P.S.C.	1/20	115	0.80	3200	Sleeve	CWSE	---
UFB143	S.P.	1/50	115	0.95	3000	Sleeve	CWSE	RFB143, A143



**New Product**

## York

Stock #	Type	HP	Volts	Amps.	RPM	Bearings	Rotation	Replaces
771	S.P.	1/70	208-230	0.49	3000	Ball	CWLE	RFB63, A063
770	S.P.	1/70	208-230	0.49	3000	Ball	CWLE	RFB5, A1063
9455	S.P.	1/30	208-230	0.60	3000	Sleeve	CCWLE	RFB144, A144
A168	P.S.C.	1/20	115	0.70	3450	Ball	CWSE	RFB540
A220	S.P.	1/20	115	1.60	3000	Ball	CWSE	---
A221	S.P.	1/40	208-230	0.60	3000	Sleeve	CCWSE	---
A223	S.P.	1/30	208-230	0.64	3200	Sleeve	CWSE	---
A224	S.P.	1/18	115	0.80	3450	Sleeve	CWSE	RFB225
A226	S.P.	1/35	115	1.70	3000	Ball	CWSE	RFB158
A227	P.S.C.	1/25	115	0.70	3450	Sleeve	CWSE	---
A228	S.P.	1/25	115	2.00	3000	Ball	CWSE	---
A229	S.P.	1/25	115	1.75	3000	Ball	CWSE	---
A230	P.S.C.	1/20	115	0.80	3450	Sleeve	CWSE	---
A231	S.P.	1/75	115	1.30	3000	Sleeve	CWSE	---
A234	P.S.C.	1/12	208-230	1.00	3200	Ball	CWSE	---
UFB251	S.P.	1/50	115	1.10	3000	Ball	CWSE	RFB251
UFB137	P.S.C.	1/25	115	0.70	3450	Sleeve	CWSE	RFB137, A137
UFB154	S.P.	1/30	115	1.20	3000	Sleeve	CWSE	RFB154, A154
UFB165	P.S.C.	1/25	115	0.70	3450	Ball	CWSE	RFB165, A165
UFB225	S.P.	1/15	115	2.25	3200	Ball	CWSE	---
UFB589	P.S.C.	1/12	115	0.73	3200	Ball	CCWSE	---
UFB654	S.P.	1/16	230-460	1.20/0.60	3000	Ball	CWSE	RFB654, YVA2460
UFB655	S.P.	1/16	230-460	1.20/0.60	3000	Ball	CWSE	RFB655, YVA2460L

**Features:**

- Shaded Pole & P.S.C. Design
- Open & Totally Enclosed
- 60 Hz
- Sleeve Bearings
- Thermally Protected

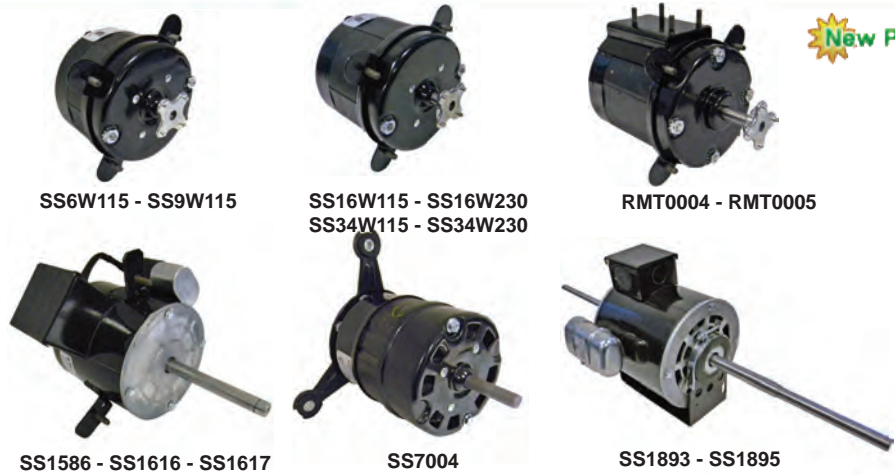

**New Product**

SS6W115 - SS9W115

SS16W115 - SS16W230  
SS34W115 - SS34W230

RMT0004 - RMT0005

SS1586 - SS1616 - SS1617

SS7004

SS1893 - SS1895

OMNIDRIVE®	Stock #	Watts	HP	Volts	Amps.	RPM	Shaft	Rotation
New	SS6W115	6	---	115	0.41	1550	Hubless	CCWSE
New	SS9W115	9	---	115	0.58	1550	Hubless	CCWSE
New	SS16W115	16	---	115	0.89	1550	Hubless	CCWSE
New	SS16W230	16	---	230	0.50	1550	Hubless	CCWSE
New	SS34W115	34	---	115	1.60	1550	Hubless	CCWSE
New	SS34W230	34	---	230	0.80	1550	Hubless	CCWSE
New	RMT0004 ●	34	---	115	1.60	1550	Hubless	CCWSE
New	RMT0005 ●	34	---	230	0.80	1550	Hubless	CCWSE
New	SS1586 ●*	41	1/20	115	1.07	1550/2	1/2" x 3-29/32"	CWSE
New	SS1616 ●*	---	1/8	115	2.16	1550/2	1/2" x 3-3/4"	CWSE
New	SS1617 ●*	---	1/4 - 1/8	115	2.52 / 1.22	1090	1/2" x 3-1/2"	CWSE
New	SS1893 ●*	50	1/15	115	0.82	1550/6	7-3/4" x 1/2" x 7-3/4"	CWSE
New	SS1895 ●*	420	1/4	115	3.60	1550/6	8-7/16" x 1/2" x 8-7/16"	CWSE
New	SS7004 ●*	40	1/15	115	0.93	1550/2	5/16" x 1-7/16"	CCWSE

**Fan Coil Motors**



**42 Frame**



Formerly A.O. Smith Electrical Products Company



Stock #	Encl.	HP	Volts	Amps.	RPM	Shaft	Rotation
89	OPEN	1/10	115	3.20	1050/5	10-11/16" x 1/2" x 10-11/16"	DBL
UE89P *	OPEN	1/10	115	2.50	1050/5	10-1/2" x 1/2" x 10-1/2"	DBL
93V1	OPEN	1/10	115	3.20	1050/5	10" x 3/8" x 10"	DBL
320	OPEN	1/15	208-230	1.30	1050/3	8-7/8" x 1/2" x 8-7/8"	DBL
362 *	OPEN	1/10	115	1.70	1075/4	10-11/16" x 1/2" x 10-11/16"	DBL
381 *	OPEN	1/10	208-230	0.81	1075/3	10-11/16" x 1/2" x 10-11/16"	DBL
953 *	OPEN	1/15	115	0.80	1100/3	10-1/2" x 1/2" x 10-1/2"	DBL
945A *	OPEN	1/8	115	1.20	1500/3	9" x 1/2" x 7-1/2"	DBL
955 *	OPEN	1/6	115	2.00	1500/3	10-1/2" x 1/2" x 10-1/2"	DBL
UE955 *	OPEN	1/6	115	2.30	1500/3	10-1/2" x 1/2" x 10-1/2"	DBL
954 *	OPEN	1/30	115	0.60	1100/3	1/2" x 8-1/2"	CCWSE
9608 *	OPEN	1/20	115	0.60	1100/3	1/2" x 9-1/2"	REV.

(●) Ball Bearing (\*) P.S.C. Design

**Features:**

- All Angle Mount
- Continuous Duty, Air Over
- Class 'B' Insulation
- Shaded Pole
- Thermally Protected
- Single, Two & Three Speed Models
- Variable Speed Model
- Sleeve Bearings



3.3" Diameter



Stock #	Volts	Amps.	RPM	Reference	Replaces
UB1	115	1.20	3000	General Replacement	RB1
UB3	120	0.80	3000	General Replacement	RB3
UB4	115	0.88	3000	Radiant Tube Heaters	RB4
UB5	115	0.40	1550	Radiant Tube Heaters	RB5
UB160	115	1.10	1550	General Replacement	RB160
UB168	120	1.00	3000	Heat & Glow	RB168B
UB200T-2	120	0.80	1600/3	Elmira Woodstove	RB200T-2
UB265	115	1.40	1630	General Replacement	RB265
UB465	115	2.60	1550/2	General Replacement	RB465
UFB500	120	1.10	2860	Greenhouse	RFB500
13	115	1.00	3000	Radiant Tube Heaters	---

## Inline Centrifugal Fans

**Features:**

- Installs in any Position
- High Pressure & Volume
- Supplied with 8 Foot Cord & Plug
- Mounting Bracket Included
- Backwards Inclined Fan Blades
- Steel Housing, Baked Powder Coat Finish
- Permanently Sealed Ball Bearings
- Three Year Warranty



All Models

Stock #	Duct Diameter	CFM	Watts	Volts	Amps.	Hz.	dBa
VENT-100 ●	4 INCH	175	98	120	0.97	60	0.90
VENT-150 ●	6 INCH	435	130	120	0.97	60	1.00
VENT-200 ●	8 INCH	745	210	120	1.76	60	1.90
VENT-250 ●	10 INCH	785	230	120	2.00	60	1.90
VENT-315 ●	12 INCH	1075	295	120	2.50	60	2.60



**New Product**



## OEM Replacements

**OMNIDRIVE®**

Stock #	Encl.	HP	Volts	Amps.	RPM	Shaft	Rotation	Replaces
11811 *	OPEN	1/6	120	2.10	1630/2	3/8" x 1.90"	CCWSE	Venmar/ VanEE
12026 ~*	OPEN	1/8	120	1.89	1630/3	2.93" x 3/8" x 2.93"	CWLE	Venmar/ VanEE
12027 ~*	OPEN	1/12	120	1.20	1625/3	3.50" x 3/8" x 3.56"	CWLE	Venmar/ VanEE
SS348 *	OPEN	1/15	115	1.30	1550/2	3/8" x 3.00"	CWSE	Venmar/ VanEE
SS438 *	OPEN	1/14	115	1.46	1625/2	5/16" x 1.88"	CCWSE	Venmar/ VanEE
SS462 ~*	OPEN	1/12	120	1.20	1625/3	3.50" x 3/8" x 3.56"	CWLE	Venmar/ VanEE
950-1020	OPEN	1/25	115	1.37	3000	5/16" x 2-1/4"	CCWSE	Tjernlund
950-1021 *	OPEN	1/7	115	1.50	3300	3/8" x 2.25"	CCWSE	Tjernlund
950-1022 ●*	OPEN	1/5	115	2.80	1700	1/2" x 3.40"	CCWSE	Tjernlund
<b>New</b> 950-3022	OPEN	1/50	115	1.00	1600	5/16" x 4-1/8"	CWSE	Tjernlund
SS2224	OPEN	1/114	115	0.75	1500/2	3/8" x 2-3/4"	CWSE	Loren Cook
SS2497	OPEN	1/10	115	3.40	1100	1/2" x 1-5/8"	CWSE	Lomanco
SS2655 ●*	OPEN	1/12	120	1.34	1550	3/8" x 2.82"	CCWLE	Nutech
SS3234	OPEN	1/16	115	2.20	1550/2	3/8" x 2-1/2"	CWSE	Loren Cook
SS4200	OPEN	1/23	115	1.50	1500	3/8" x 2-3/4"	CWSE	Loren Cook
SS5200 *	OPEN	1/16	115	1.50	1500	3/8" x 2-1/4"	CWSE	Loren Cook
SS6264	OPEN	1/11	115	4.60	1500/2	1/2" x 6-1/4"	CWSE	Loren Cook
SS7274 *	OPEN	1/4	115	3.90	1625/2	1/2" x 6-1/4"	CWSE	Loren Cook
SS8318 *	OPEN	1/8	115	2.60	1550/3	1/2" x 2-3/4"	CCWSE	Greenheck
SS9316	OPEN	---	115	3.40	1100	1/2" x 3-7/8"	CWSE	Broan
SS9317	OPEN	---	115	4.30	1100	1/2" x 3-7/8"	CWSE	Broan
30080058	OPEN	1/100	115	0.61	1050	5/16" x 1-7/8"	CCWSE	Broan
30080135 *	OPEN	1/10	120	1.80	1050	1/2" x 2-3/8"	CWSE	Broan
<b>New</b> C06E2A *	OPEN	1/8	115	1.40	1600	1/2" x 3.00"	CWSE	Loren Cook
<b>New</b> C07E4A *	OPEN	1/6	115	1.80	1100	1/2" x 3.43"	CWSE	Loren Cook
<b>New</b> C09E4A *	OPEN	1/3	115	4.80	1080	1/2" x 3.00"	CCWSE	Loren Cook
<b>New</b> C10E10A ●*	OPEN	1/2	120	6.20	1500/1300	1/2" x 3.25"	CWSE	Loren Cook

(●) Ball Bearing (\*) P.S.C. Design (-) Double Shaft

### Features:

- Shaded Pole & P.S.C. Design
- Capacitor Included
- Open Air-Over Design
- Wiring Harness w/Plug Supplied
- Long Life Self Aligning Sleeve & Sealed Ball Bearings

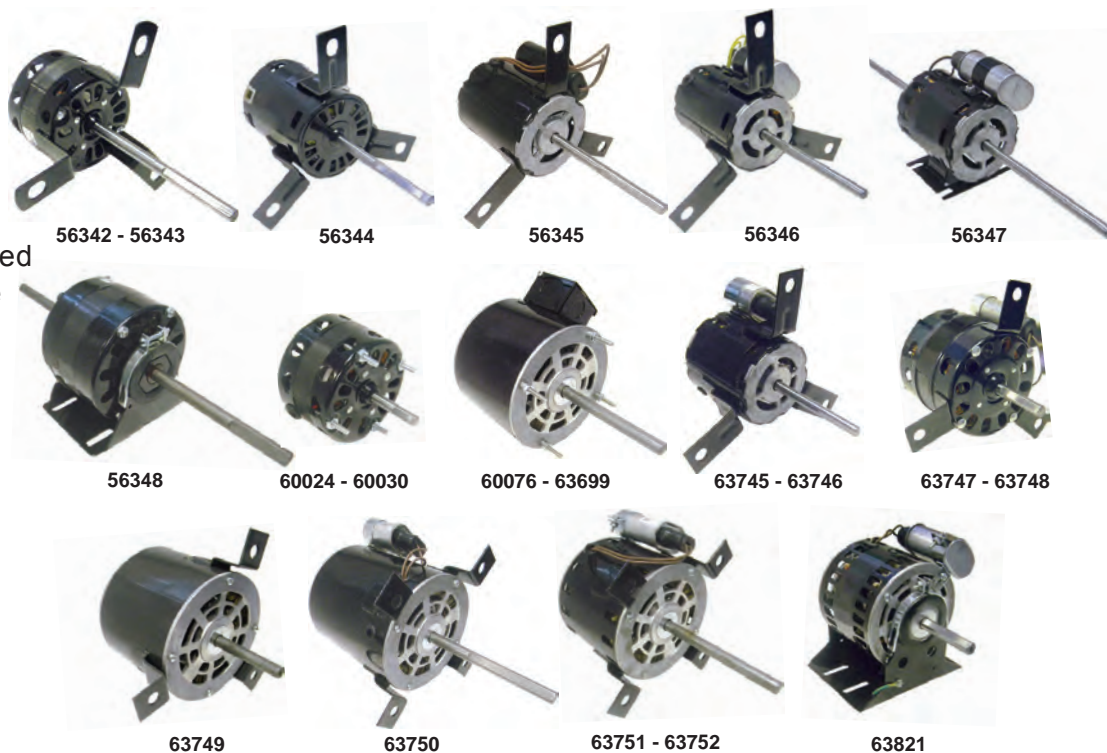

### OEM Replacements

OMNIDRIVE®

Stock #	Diameter	HP	Volts	Amps.	RPM	Shaft	Rotation	Replaces
56342	3.3"	1/70	115	1.00 / 0.50	1550/2	3/8" x 5-1/2"	CWSE	56342-0
56343	3.3"	0.27	115	1.32	1550/2	3/8" x 5-3/4"	CWSE	56343-0, JA2M414
56344 ●*	3.3"	0.08	115	1.60 / 1.00	1550/2	3/8" x 4.75"	CWSE	56344-0, JE2H047
56345 *	3.3"	1/25	115	1.00	1050	3/8" x 4.75"	CWSE	56345-0
56346 ●*	3.3"	0.27	115	3.20 / 1.90	1550/2	3/8" x 5.50"	CWSE	56346-0, JE2K007
56347 ~*	3.3"	1/12	115	1.60	1050	6.10" x 3/8" x 6.10"	CCWLE	56347-0
56348 ~	5.0"	1/10	115	3.90	1050	6-1/4" x 1/2" x 6-1/4"	CCWLE	56348-0
60024	3.3"	1/30	115	1.40	1550	5/16" x 1-1/2"	CWSE	60024-0
60030	3.3"	1/80	115	0.74	1400	1/4" x 1-3/4"	CWSE	60030-0
60076 ●*	5.5"	1/6	115	3.40	1300/2	1/2" x 2.65"	CWSE	60076-0
63699 ●*	5.5"	1/4	115	3.40	1725	1/2" x 4.77"	CWSE	63699-0
63745 *	3.3"	1/30	115	0.50 / 0.40	1550/2	3/8" x 3.69"	CWSE	63745-0
63746 ●*	3.3"	1/12	115	1.50 / 0.90	1550/2	3/8" x 3.40"	CWSE	63746-0, JE2H057
63747 *	4.4"	1/7	115	2.50	1550/3	1/2" x 2.20"	CWSE	63747-0
63748 *	4.4"	1/6	115	1.80	1550/3	1/2" x 2.60"	CWSE	63748-0
63749 ●*	5.5"	1/4	115	2.80	1725	1/2" x 3.00"	CWSE	63749-0
63750 ●*	5.5"	1/3	115	4.00	1550/3	1/2" x 5.55"	CWSE	63750-0
63751 ●*	5.5"	1/2	120	5.00	1650/2	1/2" x 5.50"	CWSE	63751-0
63752 ●*	5.5"	3/4	115	8.60 / 9.60	1625	1/2" x 5.33"	CWSE	63752-0
63821 ●*	5.0"	1/4	115	2.70	1550	1/2" x 2.60"	CCWSE	63821-0

**New Product**

**Features:**

- Totally Enclosed, Air Over
- Sleeve Bearings
- S.P. & P.S.C. Designs
- Capacitor Mounted
- Resilient Base (SS2380)



42 Frame

OMNIDRIVE®	Stock #	Encl.	HP	Volts	Amps.	RPM	Shaft	Rotation	Replaces
	SS6920	T.E.	1/15	115	2.70	1050	3/8" x 3.55"	CWSE	R6920
	SS2360	T.E.	1/15	115	2.30	1050	1/2" x 2.80"	CWSE	R2360
	SS2615	T.E.	1/8	115	4.60	1050	1/2" x 3.30"	CWSE	R2615
	SS2380 *	T.E.	1/8	115	2.30	1075	1/2" x 3.00"	CWSE	R2380
	J020P •*	T.E.	1/10	115	1.60	1550	1/2" x 3.93"	CWSE	---

**Features:**

- Totally Enclosed, Air Over
- Ball Bearings
- P.S.C. Design
- Capacitor Mounted

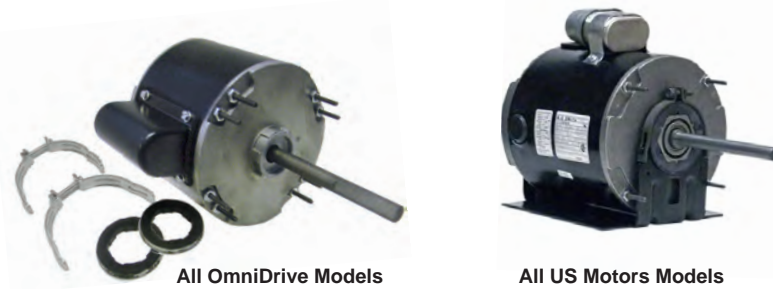



48 Frame

OMNIDRIVE®	Stock #	Encl.	HP	Volts	Amps.	RPM	Shaft	Rotation	Replaces
	SS749 *	T.E.	1/6	115	2.40	1075	1/2" x 3.50"	REV.	UH9034
	SS750 *	T.E.	1/4	115	4.10	1075	1/2" x 3.50"	REV.	UH9035
	SS751 *	T.E.	1/3	115	5.00	1075	1/2" x 3.50"	REV.	UH9036

48 Frame

	Stock #	Encl.	HP	Volts	Amps.	RPM	Shaft	Rotation	Replaces
	<b>New</b> EM-1191	T.E.	1/4	115/230	3.5/1.8	1140	1/2" x 5.10"	REV.	X3031D734
	<b>New</b> EM-1255 *	T.E.	1/4	115/230	2.5/1.3	1725	1/2" x 5.00"	REV.	UE767A
	<b>New</b> EM-1900	T.E.	1/3	115/208-230	4.2/2.1	1140	1/2" x 4.50"	REV.	X3041D732
	<b>New</b> EM-1195 •*	T.E.	1/2	115/230	5.8/2.8	1140	1/2" x 4.50"	REV.	UE733A
	<b>New</b> EM-1899 *	T.E.	1/2	115/230	5.6/2.8	1725	1/2" x 4.50"	REV.	UE769A

56 Frame

Century®	Stock #	Encl.	HP	Volts	Amps.	RPM	Shaft	Rotation	Replaces
	C060 •*	T.E.	3/4	115/230	7.30/3.70	1075	5/8" x 1-7/8"	CCWLE	---
	EM-6326 •*	T.E.	1/4	115	5.00	1725	1/2" x 2.00"	REV.	---

(•) Ball Bearing (\*) P.S.C. Design

## Features:

- Open Construction
- Split Phase Design
- Sleeve & Ball Bearings
- Manual Overload Protector



158671 - 158672



OL2002 - EL2002V1  
OL2032 - OL2052D



EL2004V1 - EL2012 - EL2014V1



**New Product**



EM-2302



OBK6002V1



EL2024 - EL2034



OL1032D - OL1052DS - OL1072D

## 48 Frame



Formerly A.O. Smith Electrical Products Company



Formerly Emerson Motors



Stock #	Encl.	HP	Volts	Amps.	RPM	Frame	Rotation	Replaces
EL2004V1	OPEN #	1/8	115	2.50	1725	48N	REV.	R6102
OL2002	OPEN	1/8	115	2.80	3450	48N	REV.	R2097
EL2002V1	OPEN #	1/7	115	2.50	3450	48M	CCWOSE	R3083
OBK6002V1 •*	OPEN	1/7	115	1.70	3450	48M	CWOSE	R21805U
EL2012	OPEN #	1/6	115	2.70	3450	48M	REV.	R3251
EL2014V1	OPEN #	1/6	115	3.20	1725	48N	REV.	R3250
EM-2302 •	OPEN	1/4	115	3.70	3450	48N	REV.	R2302
EL2024	OPEN #	1/4	115	3.70	1725	48N	REV.	R3579
OL2034	OPEN	1/3	115	4.30	1725	48N	REV.	R2303
OL2032	OPEN	1/3	115/230	4.2/2.1	3450	48N	REV.	---
OL1032D	OPEN	1/3	115/230	12.6/5.2	3450	48N	REV.	---
158671 •	ODP	1/3	115/230	7.2/3.6	3600	56C	CWLE	---
OL2052D	OPEN	1/2	115/230	6.2/3.1	3450	48N	REV.	---
OL1052DS	OPEN	1/2	115/230	7.3/3.7	3450	48N	REV.	---
158672 •	ODP	1/2	115/230	8.0/4.0	3600	56C	CWLE	---
OL1072D •	OPEN	3/4	115 / 208-230	10.0/5.0	3450	48CZ	REV.	---

(#) Enclosed Construction When Mounted

## Motor Mount Brackets & Capacitors



EM-39



EM-43 - EM-44

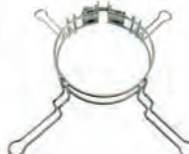

EM-24 - EM-29



EM-17 - EM-23



1482A



POC5-1 - POC7.5-1  
POC10-1 - POC15-1

## Accessories

Stock #	Description
EM-43	5" (42 Frame) 9" & 10" B.C.D. 3 Lugs
EM-44	5-5/8" (48 Frame) 9" & 10" B.C.D. 3 Lugs
EM-39	5-5/8" (48 Frame) 9" & 10" B.C.D. 4 Lugs
EM-17	Heavy Duty 5-5/8" (48 Frame) 10" B.C.D. 3 Lugs
EM-23	Heavy Duty 5-5/8" (48 Frame) 11" B.C.D. 3 Lugs
EM-24	Heavy Duty 5-5/8" (48 Frame) 15" B.C.D. 4 Lugs
EM-29	Heavy Duty 5-5/8" (48 Frame) 16" B.C.D. 4 Lugs
1482A	Capacitor Mounting Bracket & Rubber Cover
POC5-1	5mfd / 370V. Oval Case
POC7.5-1	7.5mfd / 370V. Oval Case
POC10-1	10mfd / 370V. Oval Case
POC15-1	15mfd / 370V. Oval Case

**Features:**

- Resilient Rings Included
- Permanent Split Capacitor Design
- Reversing Plug
- Extended Thru Bolts
- Thermally Protected
- 40°C Ambient Rating
- Long Life Self-Aligning Sleeve Bearings



EM-1390 - EM-1391



All OmniDrive Models

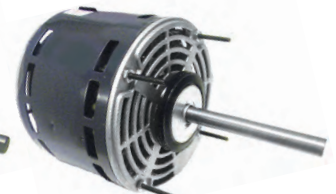

EM-8906 - EM-8907  
5BD1076 - 5BD1106

**42 Frame - Three Speed**



Stock #	Encl.	HP	Volts	Amps.	RPM	Shaft	Rotation	Replaces
EM-1390 *	OPEN	1/4	115	2.80	1075/3	1/2" x 4.00"	REV.	D150
EM-1391 *	OPEN	1/4	208-230	1.50	1075/3	1/2" x 4.00"	REV.	D151

**48 Frame - Three Speed**



Stock #	Encl.	HP	Volts	Amps.	RPM	Shaft	Rotation	Replaces
SS3583 *	OPEN	1/4	115	4.20	1075/3	1/2" x 4-1/2"	REV.	DD-3583
SS3584 *	OPEN	1/4	208-230	2.00	1075/3	1/2" x 4-1/2"	REV.	DD-3584
SS1314 *	OPEN	1/3	115	6.00	1075/4	1/2" x 5-1/8"	CCWLE	DD-1314 F1314D
SS3585 *	OPEN	1/3	115	5.50	1075/3	1/2" x 4-1/2"	REV.	DD-3585
SS3586 *	OPEN	1/3	208-230	2.80	1075/3	1/2" x 4-1/2"	REV.	DD-3586
SS3587 *	OPEN	1/2	115	7.50	1075/3	1/2" x 4-1/2"	REV.	DD-3587
SS3588 *	OPEN	1/2	208-230	3.60	1075/3	1/2" x 4-1/2"	REV.	DD-3588
SS3589 *	OPEN	3/4	115	10.20	1075/3	1/2" x 4-1/2"	REV.	DD-3589
SS3590 *	OPEN	3/4	208-230	5.50	1075/3	1/2" x 4-1/2"	REV.	DD-3590
EM-8906 ● *	OPEN	1	115	12.30	1075/3	1/2" x 6-7/16"	REV.	R42812
EM-8907 ● *	OPEN	1	208-230	5.10	1075/3	1/2" x 6-7/16"	REV.	R42023
5BD1076 ● *	OPEN	3/4	575	2.30	1075/2	1/2" x 5.00"	REV.	HQ1095096
5BD1106 ● *	OPEN	1	575	2.40	1075/2	1/2" x 5.00"	REV.	F1575DD

**Features:**

- Fits 9" & 10" Bolt Circle Diameter
- Permanent Split Capacitor Design
- Reversing Plug
- Thermally Protected
- 40°C Ambient Rating
- Long Life Self-Aligning Sleeve Bearings



All Models

**48 Frame - Four Speed**



Stock #	Encl.	HP	Volts	Amps.	RPM	Shaft	Rotation	Replaces
SS752 *	OPEN	1/4	115	3.60	1075/4	1/2" x 6.00"	REV.	DD-034
SS753 *	OPEN	1/3	115	4.80	1075/4	1/2" x 6.00"	REV.	DD-035
SS754 *	OPEN	1/2	115	8.20	1075/4	1/2" x 6.00"	REV.	DD-036
SS973 *	OPEN	1/3	208-230	2.30	1075/4	1/2" x 6.00"	REV.	DD-045
SS974 *	OPEN	1/2	208-230	3.80	1075/4	1/2" x 6.00"	REV.	DD-046

(●) Ball Bearing (\*) P.S.C. Design



# Ultimate Truck Stock Motor™

**Features:**

- High Efficiency P.S.C. Design
- Extended Mounting Studs
- Designed for Use With 370V Capacitors
- Class 'B' Insulation
- 36" Leads
- Includes Side Shell Holes For Rheem Units
- Continuous Duty, Air Over
- Reversible Rotation
- Automatic Reset Thermal Overload Protector
- 2.5" Diameter Hub Rings Included
- Sleeve and Ball Bearings



All Models

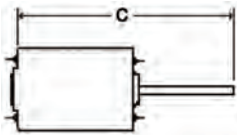

48 Frame - Four Speed



Stock #	Encl.	HP	Volts	Amps.	RPM	"C" Dim.	Shaft	Rotation
EM-5469 *	OPEN	1/3	208-230	2.40	825/4	6.74"	1/2" x 2.20"	REV.
EM-5460 *	OPEN	1/2	115	7.30	1075/4	9.80"	1/2" x 5.00"	REV.
EM-5461 *	OPEN	1/2	208-230	3.60	1075/4	9.80"	1/2" x 5.00"	REV.
EM-5470 ●*	OPEN	3/4	115	8.10	1075/4	11.60"	1/2" x 5.00"	REV.
EM-5471 ●*	OPEN	3/4	208-230	4.10	1075/4	11.60"	1/2" x 5.00"	REV.

### Cross Reference

	Rotom	Genteq	A.O. Smith	Marathon	Fasco
EM-5469	N/A	N/A	N/A	N/A	N/A
EM-5460	R6-R43600	3463	FDL6001A	X077	D2835
EM-5461	R6-R43601	3464	FD6000A	X073	D833
EM-5470	R6-R43602	3466	FDL6002A	X074	D2832
EM-5471	R6-R43603	3467	FD6001A	X075	D2833



# RESCUE Select®

**Features:**

- **The ECM Aftermarket Motor that Replaces OEM Constant Torque Blower Motors**
- Electronically Controlled Brushless Permanent Magnet Motor
- Saves 25% of the Watts in A/C or Heating
- 75% Watt Reduction in Circulation Mode
- A Variety of Mounting Kits are Available
- Electronically Protected Motor
- Continuous Duty, Air Over
- 6000V Surge Protection
- No Capacitor Required
- Voltage 230V or 115V
- Up to 82% Efficiency
- Reversible Rotation
- Class 'B' Insulation
- 2 Year Warranty
- 40°C Ambient
- Ball Bearings



Replaces Over 900 OEM X13®† and SelecTech®† ECM Motors

Now Customized for You and Shipped Same Day from Stock !

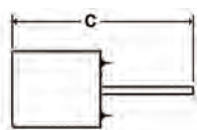

## 48 Frame



Stock #	Encl.	HP Range	Volts	Amps.	RPM	"C" Dim.	Shaft	Rotation
EM-6630RS	OPEN	1/2 - 1/3	115	6.40	600/1200	11.75"	1/2" x 5.50"	REV.
EM-6640RS	OPEN	3/4	115	9.30	600/1200	12.25"	1/2" x 5.50"	REV.
EM-6650RS	OPEN	1	115	10.60	600/1200	12.75"	1/2" x 5.50"	REV.
EM-6631RS	OPEN	1/2 - 1/3	208 / 230	4.60 / 4.30	600/1200	11.75"	1/2" x 5.50"	REV.
EM-6641RS	OPEN	3/4	208 / 230	6.30 / 6.10	600/1200	11.25"	1/2" x 5.50"	REV.
EM-6651RS	OPEN	1	208 / 230	6.40 / 6.60	600/1200	12.75"	1/2" x 5.50"	REV.



# RESCUE EcoTech®

**Features:**

- Electronically Controlled Brushless Permanent Magnet Motor
- Up to 82% Efficiency
- Saves 25% of the Watts in A/C or Heating
- 75% Watt Reduction in Circulation Mode
- Easy Voltage Change from 230V to 115V
- Electronically Protected Motor
- Continuous Duty, Air Over
- No Capacitor Required
- 6000V Surge Protection
- Reversible Rotation
- Class 'B' Insulation
- 36" Leads
- 40°C Ambient
- Ball Bearings



All Models

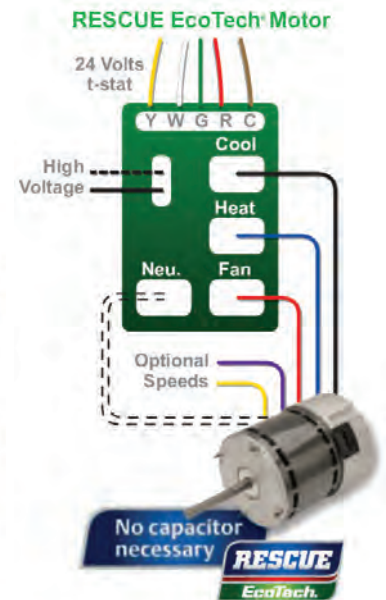

Actual connections may vary

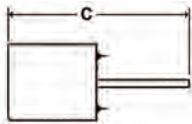

48 Frame - Five Speed



Stock #	Encl.	HP Range	Volts	Amps.	RPM	"C" Dim.	Shaft	Rotation
EM-5522ET •	OPEN	1/3 - 1/5	115 / 230	4.02 / 2.70	1075/5	9.75"	1/2" x 4.50"	REV.
EM-5532ET •	OPEN	1/2 - 1/4	115 / 230	6.20 / 3.90	1075/5	9.75"	1/2" x 4.50"	REV.
EM-5542ET •	OPEN	3/4 - 1/3	115 / 230	8.50 / 5.20	1075/5	10.75"	1/2" x 4.50"	REV.
EM-5552ET •	OPEN	1 - 1/2	115 / 230	11.50 / 6.90	1075/5	11.25"	1/2" x 4.50"	REV.

## Cross Reference

	Rotom	Genteq	Mars	A.O. Smith
EM-5522ET	N/A	6103E *	N/A	N/A
EM-5532ET	R6-R75531 R6-R755301	6105E *	06005	CSL1056 CS1056
EM-5542ET	N/A	6107E *	N/A	N/A
EM-5552ET	R6-R75551 R6-R755501	6110E *	06010	CSL1106 CS1106

(\* ) 115 Volt Only

- **Fits a Wide Variety of Applications** – The fully reversible motor comes in a range of horsepower sizes to fit your market and is dual voltage so you can provide an indoor blower solution to all your customers.
- **Quiet, Efficient Circulation Speed** – With a low 600 RPM circulation speed, your customers can cycle air continuously without the noise, draft or electricity cost of a PSC motor. Often using less energy than a 100 watt bulb. Up to 75% watts savings are typical.
- **Active Airflow Management** – The advanced motor control reacts to change in static pressure, helping to maintain airflow as vents are closed or the filter becomes dirty.
- **Very Energy Efficient** – The RESCUE EcoTech motor is up to 25% more electrically efficient at high speed compared to a standard blower motor. 75% watt reduction in circulation mode.



**Features:**

- Open Drip-Proof
- Class 'B' Insulation
- Reversible Rotation
- 60 Hz.
- Resilient Base
- Thermally Protected
- 1/2" to 5/8" Sleeve & Key Included
- Self-Aligning Sleeve & Sealed Ball Bearings



All Models

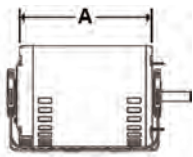

48 Frame - Single Speed

OMNIDRIVE®



Formerly Emerson Motors

Stock #	Encl.	HP	Volts	Amps.	RPM	"A" Dim.	Shaft	Rotation
SS933	OPEN	1/4	115	4.80	1725	6.81"	1/2" x 1.50"	REV.
SS934	OPEN	1/3	115	6.60	1725	6.81"	1/2" x 1.50"	REV.
SS935	OPEN	1/2	115	8.30	1725	7.76"	1/2" x 1.50"	REV.
SS934B •	OPEN	1/3	115	6.60	1725	6.81"	1/2" x 1.50"	REV.
SS935B •	OPEN	1/2	115	7.60	1725	6.81"	1/2" x 1.50"	REV.
SS933D •	OPEN	1/4	115/208-230	4.60/2.20-2.10	1725	6.75"	1/2" x 1.88"	REV.
SS934D •	OPEN	1/3	115/208-230	6.60/3.40-3.10	1725	6.75"	1/2" x 1.88"	REV.
SS935D •	OPEN	1/2	115/208-230	7.60/3.70-3.80	1725	8.58"	1/2" x 1.88"	REV.
SS936D •^	OPEN	3/4	115/208-230	11.60/5.90-5.80	1725	10.55"	5/8" x 1.88"	REV.
EM-840CV •	OPEN	1/4	115	4.80	1725	7.32"	1/2" x 1.62"	REV.
EM-841CV	OPEN	1/3	115	6.40	1725	7.93"	1/2" x 1.62"	REV.
EM-1542C •	OPEN	1/2	115	7.80	1725	8.44"	1/2" x 1.62"	REV.

(^) 56 Frame



All US Motors Models

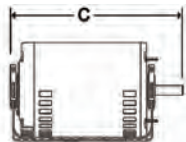

56Z Frame - Two Speed



Formerly Emerson Motors

Stock #	Encl.	HP	Volts	Amps.	RPM	"C" Dim.	Shaft	Rotation
EM-5793C •	OPEN	1/3	115	6.40	1725/1140	10.40"	1/2" x 1.50"	REV.
EM-5794C •	OPEN	1/2	115	8.70	1725/1140	10.40"	1/2" x 1.50"	REV.
EM-5795C •	OPEN	3/4	115	11.50	1725/1140	11.30"	1/2" x 1.50"	REV.

(•) Ball Bearing

### Features:

- Open Drip-Proof
- Class 'A' and 'B' Insulation
- Reversible Rotation
- Resilient Base
- 5/8" Diameter Shaft
- 40°C Ambient
- High Starting Torque
- Ball Bearings



All Models

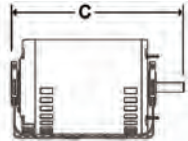

56 Frame



Stock #	Encl.	HP	Volts	Amps.	RPM	"C" Dim.	Rotation
D13CA2JH9 •	O.D.P.	1/3	115 / 208-230	8.80 / 3.90 - 4.40	1725	9.80"	REV.
EM-1790 •	O.D.P.	1/2	115 / 208-230	7.40 / 3.70	1725	9.30"	REV.
EM-1893 •	O.D.P.	3/4	115 / 208-230	11.40 / 5.70	1725	10.80"	REV.
EM-3187C •	O.D.P.	1	115 / 230	14.00 / 7.00	1725	11.80"	REV.
EM-4242 •	O.D.P.	1-1/2	115 / 208-230	22.40 / 11.20	1725	12.80"	REV.

### Cross Reference

	Rotom	Emerson	GE	Marathon	Fasco
D13CA2JH9	S1120	---	C216	C216	D6082
EM-1790	S1146	1790	C1153	B317	D6084
EM-1893	S1174	1893	C1156	B319	D6086
EM-3187C	S1199	3187C	C1158	C1159	D6088
EM-4242	S1336	4242	C1160	C1160	D6090

**Features:**

- Resilient Base and Rigid Base
- Reversible Rotation
- 5/8" Diameter Shaft
- Open Drip-Proof
- 40°C Ambient
- Ball Bearings

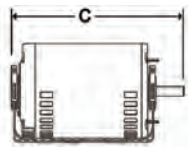

56 Frame



Stock #	HP	RPM	Volts	Amps.	Frame	Shaft Dia.	Base
H840	1/2	1800	460/200-230	1.00/1.9-2.0	56	5/8	Resilient
H940V1	1/2	1800	575	0.70	56	5/8	Resilient
H851V2	3/4	1800	460/200-230	1.50/2.8-3.0	56	5/8	Resilient
H941L	3/4	1800	575	0.90	56	5/8	Resilient
H842V1	1	3600	460/200-230	1.80/3.5-3.6	56H	5/8	Resilient
H950	1	3600	575	1.50	56H	5/8	Resilient
H852L	1	1800	460/200-230	2.00/3.7-4.0	56H	5/8	Resilient
H942	1	1800	575	1.50	56H	5/8	Resilient
H882	1	1800	460/200-230	2.00/3.7-4.0	56H	5/8	Rigid
H883	1	1800	460/200-230	1.90/3.5-3.8	56HZ	7/8	Rigid
H843V1	1.5	3600	460/200-230	2.30/4.7-4.6	56H	5/8	Resilient
H944	1.5	3600	575	1.80	56H	5/8	Resilient
H853V2	1.5	1800	460/200-230	2.80/5.0-5.6	56H	5/8	Resilient
H943V1	1.5	1800	575	2.00	56	5/8	Resilient
H884L	1.5	1800	460/200-230	2.80/5.0-5.6	56H	5/8	Rigid
H885L	1.5	1800	460/200-230	2.80/5.0-5.6	56HZ	7/8	Rigid
UEH951	1.5	1800	575	2.00	56HZ	7/8	Rigid
UEH885	1.5	1800	200-230/460	5.00/2.50	56HZ	7/8	Rigid
H844	2	3600	460/200-230	2.90/6.0-5.8	56H	5/8	Resilient
H952	2	3600	575	2.40	56H	5/8	Resilient
H854	2	1800	460/200-230	3.00/6.6-7.0	56HZ	7/8	Resilient
UEH886	2	1800	460/200-230	7.60-7.8/3.9	56HZ	7/8	Rigid
UEH953	2	1800	575	2.70	56HZ	7/8	Rigid
H845	3	3600	460/200-230	4.30/9.0-8.6	56HZ	7/8	Resilient
H954	3	3600	575	3.60	56HZ	7/8	Resilient
H980L *	3	1800	208-230/460	9.00-9.0/4.5	56Y	7/8	Rigid
H855L	3	1800	460/200-230	4.40/9.0-8.8	56HZ	7/8	Rigid
UEH887	3	1800	460/200-230	4.60/9.0-9.2	56HZ	7/8	Rigid
UEH955	3	1800	575	3.40	56HZ	7/8	Rigid
H847	5	3600	460/200-230	6.60/13.4-13.2	56HZ	7/8	Rigid
H956	5	3600	575	5.40	56HZ	7/8	Rigid
H979L *	5	1800	208-230/460	15.00/7.40	56Y	7/8	Rigid

(\*) Carrier OEM Replacement

# Hot Water Circulator Pump Motors



www.uem.ca

## Features:

- Open Drip-Proof
- Single Phase & Three Phase
- Mounting Bracket
- 1800 RPM
- Permanently Sealed Ball Bearings
- Replacements for OEM Motors such as Armstrong (A), Bell & Gossett (B) & Taco (T)

Type '2A' 4.67" B.C.D. fits # 2 Bearing Assembly  
 Type '2B' 5.00" B.C.D. fits # 3 & 4 Bearing Assembly  
 Type '2C' 5.875" B.C.D. fits # 5, 6 & 7 Bearing Assembly



Type 2A & 2B



Type 2C



Type 2C

## Single Phase

OMNIDRIVE®

Stock #	HP	Volts	Amps.	Type	Bearing	Rotation	Replaces
SS1350	1/12	115	2.5	2A	Ball	CWSE	R1350
SS1355	1/6	115	3.8	2A	Ball	CWSE	----
SS1352	1/6	115	3.8	2B	Ball	CWSE	R1352
SS1354	1/4	115	4.6	2B	Ball	CWSE	R1354
SS1444	1/4	115	4.6	2C	Ball	CCWSE	R1444
SS1356	1/3	115	6.0	2B	Ball	CWSE	R1356
SS1446	1/3	115	6.0	2C	Ball	CCWSE	R1446
SS1459	1/2	115-208/230	5.7/3.0-2.9	2C	Ball	REV	R1459
SS1462	3/4	115-208/230	8.2/4.7-4.2	2C	Ball	REV	R1462
C245 ^	1	230/115	6.5/13.0	4	Ball	REV	R1463

(^) Round Body - No Bracket



Type 3



Type 4

## Three Phase



Formerly A.O. Smith Electrical Products Company

Stock #	HP	Volts	Amps.	Type	Bearing	Rotation	Replaces
H1041L	1/2	208-230/460	1.8-2.0/1.0	3	Ball	REV.	R1368
H1046	1/2	575	0.9	3	Ball	REV.	R1369
H1042L	3/4	208-230/460	2.7-2.8/1.4	3	Ball	REV.	R1370
H1047L	3/4	575	1.1	3	Ball	REV.	R1372
H982	3/4	208-230/460	2.5-2.6/1.3	4	Sleeve	REV.	(T)
H983	3/4	208-230/460	2.5-2.6/1.3	4	Sleeve	REV.	(A,B)
H1043L	1	208-230/460	3.4-3.4/1.7	3	Ball	REV.	R1371
H1048L	1	575	1.4	3	Ball	REV.	R1373
H984	1	208-230/460	3.4-3.4/1.7	4	Sleeve	REV.	(A)
H985L	1	208-230/460	3.4-3.4/1.7	4	Sleeve	REV.	(B)
H946L	1	208-230/460	3.7-3.6/1.8	4	Sleeve	REV.	(T)
H947L	1	575	1.4	4	Sleeve	REV.	(T)
H1044L	1.5	208-230/460	5.7-5.6/2.8	3	Ball	REV.	R1374
H1049V1	1.5	575	2.1	3	Ball	REV.	R1375
H986L	1.5	208-230/460	4.8-5.0/2.5	4	Sleeve	REV.	(A, B)
H987L	2	208-230/460	6.3-6.4/3.2	4	Ball	REV.	(T)
H988L	3	208-230/460	4.4/9.0-8.8	4	Ball	REV.	(T)

**Features:**

- Open Drip-Proof
- Rigid Base
- Class 'F' Insulation - Class 'B' Rise at Service Factor
- Reversible Rotation
- 1.15 Service Factor
- F-1 Assembly
- Aluminum End-Shields with Steel Inserts
- Light Weight Rolled Steel Frame
- Suitable for use with Inverters (VFD)
- Double Shielded Bearings (140 - 280 Frame)
- Lifting Provisions (210 Frame & Up)
- Regreasable Bearings (180 Frame & Up)
- Ball Bearings



**42/36 Month Warranty\***



Three Phase

Stock #	HP	Volts	Amps.	RPM	Frame	Efficiency %
D1P2D	1	208-230 / 460	3.20 / 1.50	1800	143T	85.5
D32P2D	1-1/2	208-230 / 460	4.40 / 2.10	1800	145T	86.5
D2P2D	2	208-230 / 460	5.90 / 2.80	1800	145T	86.5
D3P2D	3	208-230 / 460	8.40 - 7.80 / 3.90	1800	182T	89.5
D5P2D	5	208-230 / 460	13.80 - 13.00 / 6.50	1800	184T	89.5
D7P2D	7-1/2	208-230 / 460	20.20 - 18.50 / 9.30	1800	213T	91.0
D10P2D	10	208-230 / 460	26.30 - 23.80 / 11.90	1800	215T	91.7
D15P2D	15	208-230 / 460	40.00 - 37.00 / 18.30	1800	254T	93.0
D20P2D	20	208-230 / 460	54.00 - 49.00 / 24.40	1800	256T	93.0
D25P2D	25	208-230 / 460	64.00 - 58.00 / 29.00	1800	284T	93.6
D30P2D	30	208-230 / 460	77.00 - 69.00 / 34.00	1800	286T	94.1
D1P2G	1	575	1.30	1800	143T	85.5
D32P2G	1-1/2	575	1.70	1800	145T	86.5
D2P2G	2	575	2.20	1800	145T	86.5
D3P2G	3	575	3.20	1800	182T	89.5
D5P2G	5	575	5.20	1800	184T	89.5
D7P2G	7-1/2	575	7.20	1800	213T	91.0
D10P2G	10	575	9.80	1800	215T	91.7
D15P2G	15	575	14.80	1800	254T	93.0
D20P2G	20	575	19.20	1800	256T	93.0
D25P2G	25	575	23.00	1800	284T	94.1
D30P2G	30	575	27.70	1800	286T	94.1

(\* Note: Warranty Period is 42 Months from Date of Manufacture or 36 Months from Date of Installation on Sine Wave Power or 30 Months from Date of Manufacture or 24 Months from Date of Installation on VFD Power, whichever occurs first.

# Three Phase Motors Aluminum Frame



www.uem.ca

## Features:

- Aluminum Construction
- Totally Enclosed Fan Cooled
- 3600 RPM
- Continuous Duty
- Class 'B' Insulation
- Removable Bolt-on Feet
- Reversible
- 40°C Ambient
- UL Listed & CSA Approved
- 3 Positions for Feet Allow for F-1, F-2, F-0 Conduit Box Location
- Inverter Duty 10:1 V.T. / 2:1 C.T.
- Ball Bearings
- 1.15 S.F.

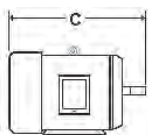

56 & 56HZ Frame

OMNIDRIVE®

Stock #	HP	Volts	Amps.	"C"	Shaft (Dia.)	Frame
WA631	1/3	208-230 / 460	1.26 - 1.14 / 0.57	12.67"	5/8"	56
WA611	1/3	575	0.46	12.67"	5/8"	56
WA632	1/2	208-230 / 460	1.82 - 1.64 / 0.82	12.67"	5/8"	56
WA612	1/2	575	0.66	12.67"	5/8"	56
WA633	3/4	208-230 / 460	2.59 - 2.34 / 1.17	12.67"	5/8"	56
WA613	3/4	575	0.94	12.67"	5/8"	56
WA634	1	208-230 / 460	3.24 - 2.92 / 1.46	13.66"	5/8"	56H
WA614	1	575	1.17	13.66"	5/8"	56H
TA624	1	208-230 / 460	3.24 - 2.92 / 1.46	14.02"	7/8"	56HZ
TA604	1	575	1.17	14.02"	7/8"	56HZ
WA635	1-1/2	208-230/460	4.71 - 4.26 / 2.13	13.66"	5/8"	56H
WA615	1-1/2	575	1.70	13.66"	5/8"	56H
TA625	1-1/2	208-230/460	4.71 - 4.26 / 2.13	14.02"	7/8"	56HZ
TA605	1-1/2	575	1.70	14.02"	7/8"	56HZ
WA636	2	208-230/460	6.02 - 5.44 / 2.72	13.66"	5/8"	56H
WA616	2	575	2.18	13.66"	5/8"	56H
TA626	2	208-230/460	6.02 - 5.44 / 2.72	14.02"	7/8"	56HZ
TA606	2	575	2.18	14.02"	7/8"	56HZ
WA637	3	208-230/460	8.76 - 7.92 / 3.96	13.66"	5/8"	56H
WA617	3	575	3.17	13.66"	5/8"	56H
TA627	3	208-230/460	8.70 - 7.96 / 3.96	14.02"	7/8"	56HZ
TA607	3	575	3.17	14.02"	7/8"	56HZ

**Features:**

- Aluminum Construction
- Totally Enclosed Fan Cooled
- 1800 RPM
- Continuous Duty
- Class 'B' Insulation
- Removable Bolt-on Feet
- Reversible
- 40°C Ambient
- UL Listed & CSA Approved
- 3 Positions for Feet Allow for F-1, F-2, F-0 Conduit Box Location
- Inverter Duty 10:1 V.T. / 2:1 C.T.
- Ball Bearings
- 1.15 S.F.

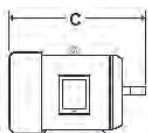

56 & 56HZ Frame

OMNIDRIVE®

Stock #	HP	Volts	Amps.	"C"	Shaft (Dia.)	Frame
WA681	1/3	208-230 / 460	1.43 - 1.30 / 0.65	12.67"	5/8"	56
WA661	1/3	575	0.52	12.67"	5/8"	56
WA682	1/2	208-230 / 460	2.12 - 1.92 / 0.96	12.67"	5/8"	56
WA662	1/2	575	0.77	12.67"	5/8"	56
WA683	3/4	208-230 / 460	2.94 - 2.66 / 1.33	12.67"	5/8"	56
WA663	3/4	575	1.06	12.67"	5/8"	56
WA684	1	208-230 / 460	3.84 - 3.48 / 1.74	13.66"	5/8"	56H
WA664	1	575	1.39	13.66"	5/8"	56H
TA674	1	208-230 / 460	3.84 - 3.48 / 1.74	14.02"	7/8"	56HZ
TA654	1	575	1.39	14.02"	7/8"	56HZ
WA685	1-1/2	208-230/460	5.28 - 4.78 / 2.39	13.66"	5/8"	56H
WA665	1-1/2	575	1.91	13.66"	5/8"	56H
TA675	1-1/2	208-230/460	5.28 - 4.78 / 2.39	14.02"	7/8"	56HZ
TA655	1-1/2	575	1.91	14.02"	7/8"	56HZ
WA686	2	208-230/460	6.73 - 6.08 / 3.04	13.66"	5/8"	56H
WA666	2	575	2.43	13.66"	5/8"	56H
TA676	2	208-230/460	6.73 - 6.08 / 3.04	14.02"	7/8"	56HZ
TA656	2	575	2.43	14.02"	7/8"	56HZ

# Three Phase Motors Aluminum Frame



www.uem.ca

## Features:

- Aluminum Construction
- Totally Enclosed Fan Cooled
- 3600 RPM
- Continuous Duty
- Class 'B' Insulation
- Removable Bolt-on Feet
- Reversible
- 40°C Ambient
- UL Listed & CSA Approved
- 3 Positions for Feet Allow for F-1, F-2, F-0 Conduit Box Location
- Inverter Duty 10:1 V.T. / 2:1 C.T.
- Ball Bearings
- 1.15 S.F.

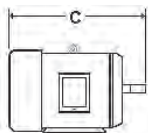

56C & 56HCZ Frame

OMNIDRIVE®

Stock #	HP	Volts	Amps.	"C"	Shaft (Dia.)	Frame
WA631C	1/3	208-230 / 460	1.26 - 1.14 / 0.57	12.67"	5/8"	56C
WA611C	1/3	575	0.46	12.67"	5/8"	56C
WA632C	1/2	208-230 / 460	1.82 - 1.64 / 0.82	12.67"	5/8"	56C
WA612C	1/2	575	0.66	12.67"	5/8"	56C
WA633C	3/4	208-230 / 460	2.59 - 2.34 / 1.17	12.67"	5/8"	56C
WA613C	3/4	575	0.94	12.67"	5/8"	56C
WA634C	1	208-230 / 460	3.24 - 2.92 / 1.46	13.66"	5/8"	56HC
WA614C	1	575	1.17	13.66"	5/8"	56HC
TA624C	1	208-230 / 460	3.24 - 2.92 / 1.46	14.02"	7/8"	56HCZ
TA604C	1	575	1.17	14.02"	7/8"	56HCZ
WA635C	1-1/2	208-230/460	4.71 - 4.26 / 2.13	13.66"	5/8"	56HC
WA615C	1-1/2	575	1.70	13.66"	5/8"	56HC
TA625C	1-1/2	208-230/460	4.71 - 4.26 / 2.13	14.02"	7/8"	56HCZ
TA605C	1-1/2	575	1.70	14.02"	7/8"	56HCZ
WA636C	2	208-230/460	6.02 - 5.44 / 2.72	13.66"	5/8"	56HC
WA616C	2	575	2.18	13.66"	5/8"	56HC
TA626C	2	208-230/460	6.02 - 5.44 / 2.72	14.02"	7/8"	56HCZ
TA606C	2	575	2.18	14.02"	7/8"	56HCZ
WA637C	3	208-230/460	8.76 - 7.92 / 3.96	13.66"	5/8"	56HC
WA617C	3	575	3.17	13.66"	5/8"	56HC
TA627C	3	208-230/460	8.70 - 7.96 / 3.96	14.02"	7/8"	56HCZ
TA607C	3	575	3.17	14.02"	7/8"	56HCZ



**Features:**

- Aluminum Construction
- Totally Enclosed Fan Cooled
- 1800 RPM
- Continuous Duty
- Class 'B' Insulation
- Removable Bolt-on Feet
- Reversible
- 40°C Ambient
- UL Listed & CSA Approved
- 3 Positions for Feet Allow for F-1, F-2, F-0 Conduit Box Location
- Inverter Duty 10:1 V.T. / 2:1 C.T.
- Ball Bearings
- 1.15 S.F.

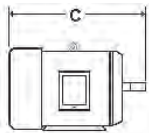

56C & 56HCZ Frame

OMNIDRIVE®

Stock #	HP	Volts	Amps.	"C"	Shaft (Dia.)	Frame
WA681C	1/3	208-230 / 460	1.43 - 1.30 / 0.65	12.67"	5/8"	56C
WA661C	1/3	575	0.52	12.67"	5/8"	56C
WA682C	1/2	208-230 / 460	2.12 - 1.92 / 0.96	12.67"	5/8"	56C
WA662C	1/2	575	0.77	12.67"	5/8"	56C
WA683C	3/4	208-230 / 460	2.94 - 2.66 / 1.33	12.67"	5/8"	56C
WA663C	3/4	575	1.06	12.67"	5/8"	56C
WA684C	1	208-230 / 460	3.84 - 3.48 / 1.74	13.66"	5/8"	56HC
WA664C	1	575	1.39	13.66"	5/8"	56HC
TA674C	1	208-230 / 460	3.84 - 3.48 / 1.74	14.02"	7/8"	56HCZ
TA654C	1	575	1.39	14.02"	7/8"	56HCZ
WA685C	1-1/2	208-230/460	5.28 - 4.78 / 2.39	13.66"	5/8"	56HC
WA665C	1-1/2	575	1.91	13.66"	5/8"	56HC
TA675C	1-1/2	208-230/460	5.28 - 4.78 / 2.39	14.02"	7/8"	56HCZ
TA655C	1-1/2	575	1.91	14.02"	7/8"	56HCZ
WA686C	2	208-230/460	6.73 - 6.08 / 3.04	13.66"	5/8"	56HC
WA666C	2	575	2.43	13.66"	5/8"	56HC
TA676C	2	208-230/460	6.73 - 6.08 / 3.04	14.02"	7/8"	56HCZ
TA656C	2	575	2.43	14.02"	7/8"	56HCZ

**MORE MOTOR KNOWLEDGE...  
 MORE MOTOR EXPERIENCE...  
 MORE MOTOR VARIETY...  
 AT YOUR SERVICE**

**WE'VE ALSO GOT YOU COVERED FOR:**

	<b>UNIT BEARING MOTORS</b>		<b>MORE OEM REPLACEMENT MOTORS</b>
	<b>ECM REFRIGERATION MOTORS</b>		<b>MORE BLOWERS</b>
	<b>PM &amp; SHUNT WOUND DC MOTORS</b>		<b>MORE 3.3" DIAMETER MOTORS</b>
	<b>COMPRESSOR DUTY MOTORS</b>		<b>MORE 4" DIAMETER MOTORS</b>
	<b>PUMP MOTORS</b>		<b>MORE 5" DIAMETER MOTORS</b>
	<b>GENERAL PURPOSE MOTORS (IHP)</b>		<b>MORE 48 FRAME MOTORS</b>
	<b>ELEVATOR DUTY MOTORS</b>		<b>MORE 56 FRAME MOTORS</b>
	<b>FARM DUTY MOTORS</b>		<b>MORE SKELETON MOTORS</b>



**WWW.UEM.CA**

INTEGRITY OF CATALOG: The information contained in this catalogue is for reference purposes only. We strive to ensure that the information is as accurate and current as possible. We are in no way responsible for any errors that may arise. We reserve the right to change specifications and other information included without prior notice. If you are concerned about the validity of the information on a certain product, please visit [www.uem.ca](http://www.uem.ca) and contact us.

DISCLAIMER: All content offered from or available in our catalogue are provided to you on an "as is" basis, without representations, warranties or conditions of any kind. You acknowledge and agree that any reliance by you on any information available in this catalogue shall be at your own risk.

All rights reserved. You may not produce, copy, modify or redistribute the design or layout of any Universal Electric Motors content without written permission.

It is important to note that Universal Electric Motors is not affiliated with any of the original equipment manufacturers or their brands which may be referred to herein. Other trade-marks featured in this catalogue are the property of their respective owners. No association between Universal Electric Motors and any trademark holder is expressed or implied. The names, descriptions, numbers and symbols featured throughout this catalogue are for cross reference purposes only.