

New! 4-in-1® 3.3" Motor

“One Simple Connection Is All You Need”

Features

- ✓ Class B Insulation
- ✓ Open
- ✓ Single Shaft
- ✓ Shaded Pole
- ✓ Heavy Duty Ball Bearing
- ✓ Thermally Protected
- ✓ Single-Speed
- ✓ Four studs on each end with extra mounting nuts

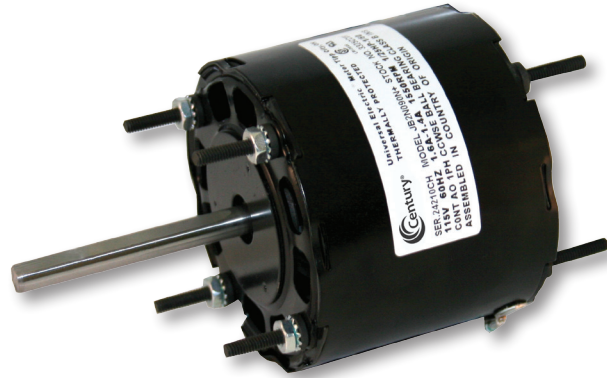

Benefits

- One motor replaces 1/25, 1/30, 1/40 & 1/50 horse powers with one simple connection
- Replaces hundreds of the most popular 3.3" motors currently installed
- Great truck stock motors and a must-have for any contractor who offers 24-hour emergency service

Stock Number	HP	RPM	Volts	Amps	Rotation Dim	Shaft Dia. & Length	“A”
3325CW	1/25-1/50	1550	115	1.6-1.4	CWSE	5/16" x 2 1/2"	2.75
3325CCW	1/25-1/50	1550	115	1.6-1.4	CCWSE	5/16" x 2 1/2"	2.75

Cross Reference

Century Stock Number	Mars	Packard	Fasco	Rotom
3325CW	05528	40030	D184	R90030
	05526	40514	D514	R90514
	05524	40126	D126	R409
				R90026
3325CCW	05527	40031	D515	R90031
	05525	40515	D127	R90027
	05523	40127		

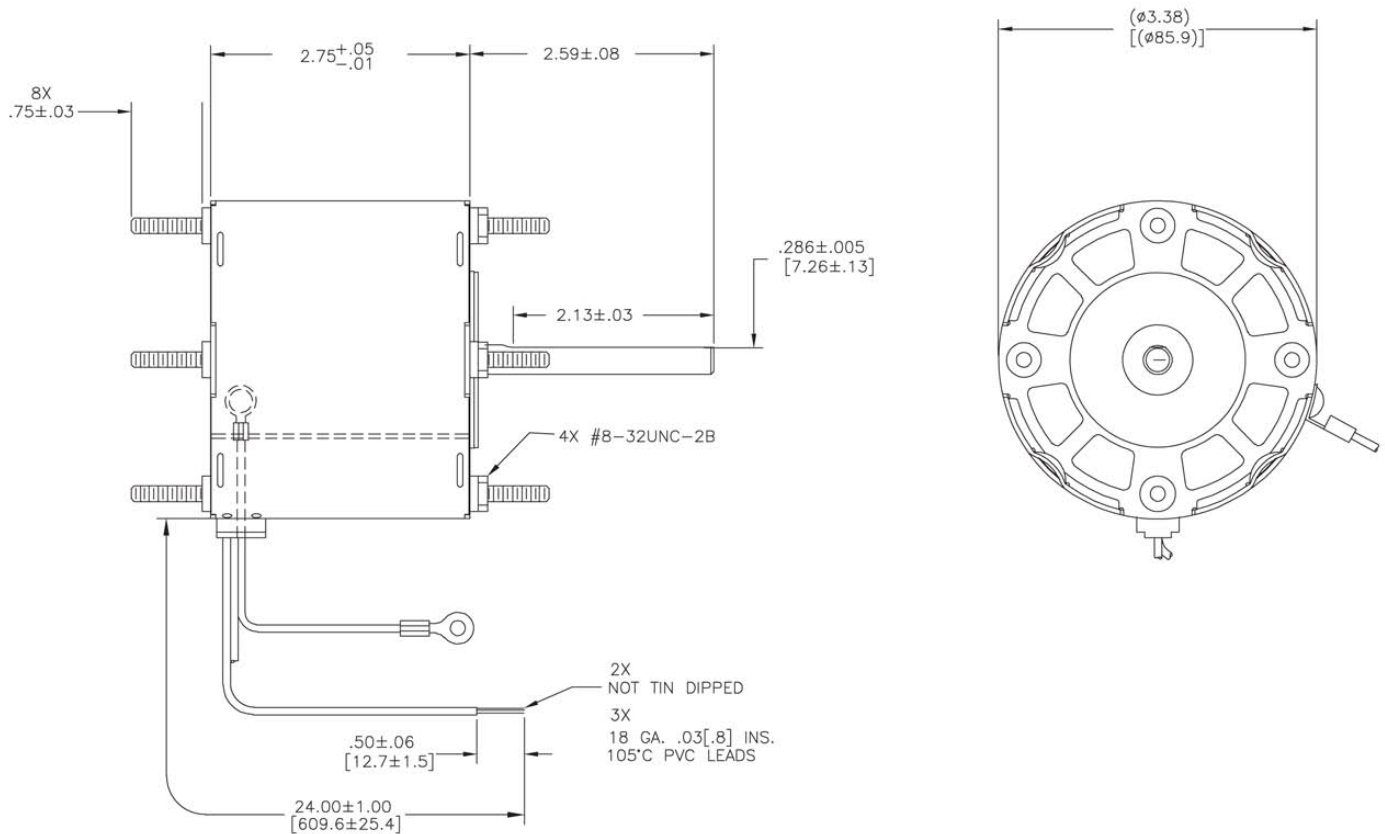

NOW AVAILABLE!
FAX OR PHONE YOUR ORDER TODAY!



Universal Electric Motors
 6200 Dixie Road, Unit 1
 Mississauga, Ontario, L5T 2E1
 Tel: (905) 670-3380
 Toll Free: 1-877-670-3380
 Fax: (905) 670-7637

A Regal Brand

